

SINAN

SE-100R-2S

**EXIT Sign + 2 Side
Heads**
Thermoplastic Housing
Self Powered

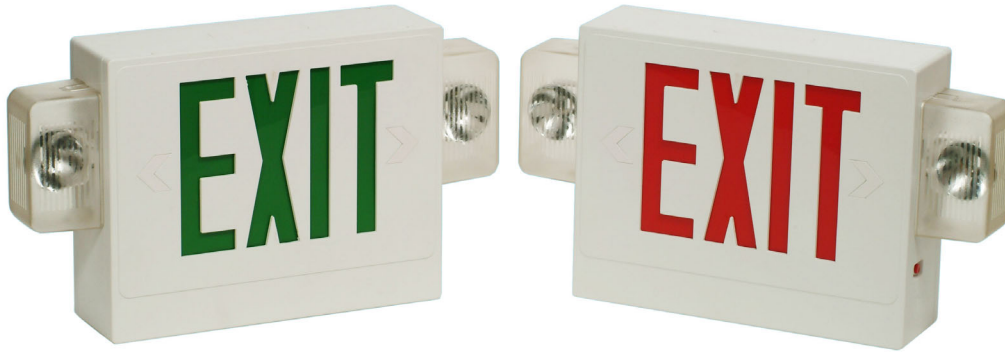

DESCRIPTION

The SE-100R-2S (LED Red) and SE-100G-2S (LED Green) are economical and energy saving Exit signs with two, side mounted emergency lighting heads. The injection molded plastic housing has soft rounded corners for aesthetic appeal. The Exit signs' LED lamps provide a maximum of energy savings potential and the battery pack allows the unit to be Self Powered during power outages.

APPLICATION

Suitable for use in almost any commercial or light industrial application. Ideal for mounting in the limited space available above doorways.

OPTIONS

Remote Heads Option. At the end of the catalog number add "R" for one remote head and "R2" for two remote head capability.

APPROVALS

UL924.
UL listed for damp locations.
Life Safety NFPA 101.

HOUSING

The housing is made of injection molded thermoplastic making it impact resistant and corrosion proof. UL94-5V rated.

MOUNTING

Easy snap fit canopy can be used for top mounting or knockouts can be used for surface mounting. Included second face allows the unit to be used as a single or double face exit sign. Snap fitting, replaceable chevrons for direction indication.

LAMPS

Long life Light Emitting Diode (LED) lamps in the Exit sign portion provide the maximum in energy savings. The emergency lighting heads have 2 x 5.4 W incandescent lamps.

ELECTRICAL/BATTERY

- Dual voltage input 120/277 VAC, 60 Hz.
- Maintenance free, Sealed Lead Calcium 6V, 4.5 AH battery with a maximum full recharge time of 48 hours. Minimum 1 ½ hour emergency operation.
- Low voltage disconnect of the battery prevents deep discharge and maintains good battery life.
- Fully automatic, solid state charger.
- Test switch with LED charge indicator/AC voltage indicator.
- Line latching feature prevents the unit from turning on during installation to a non-energized AC circuit. Saves labor since the installer does not have to return to connect the battery terminals once the building is energized.

Catalog Number	Emergency	Lamp Type EXIT Section	Lamp Type Emergency Section	Weight (Lbs)	Volume (cu. ft.)	Pieces Per Skid	Pieces Per 20'	Pieces Per 40'
SE-100R-2S	Self Powered	LED Red	2 x 5.4 W Incan.	7.0	0.50	128	1280	2560
SE-100G-2S	Self Powered	LED Green	2 x 5.4 W Incan.	7.0	0.50	128	1280	2560